

INSTALLATION PROCEDURE

1. Install metal (or wood) studs in accordance with detail drawings on each of the SOFTFORMS® specification sheets.
2. Install drywall panels of correct thickness as specified.
3. Cut SOFTFORMS® extrusions to proper length and test fit against drywall panels.
4. Prepare butt joints by beveling or swedging.
5. Fasten along entire length, 6" on center, near ends and at joints with drywall screws.
6. Trowel on joint compound and embed reinforced tape making sure it does not overlap any part of the extrusion shoulder.
7. After first coat hardens apply final skimcoat with an 8" wide flexible metal trowel. One edge of the trowel must ride along the shoulder, the other in contact with the drywall panel. The front-on appearance is flat, though the actual finish (in section) is slightly tapered.
8. Sandpaper finish any irregularities.
9. Apply final finish (paints, wallpaper, etc.) in accordance with manufacturer's instructions.
10. When using veneer plaster SOFTFORMS® fin must be treated with a bonding agent.

SAMPLE SECTION 90° OUTSIDE CORNER

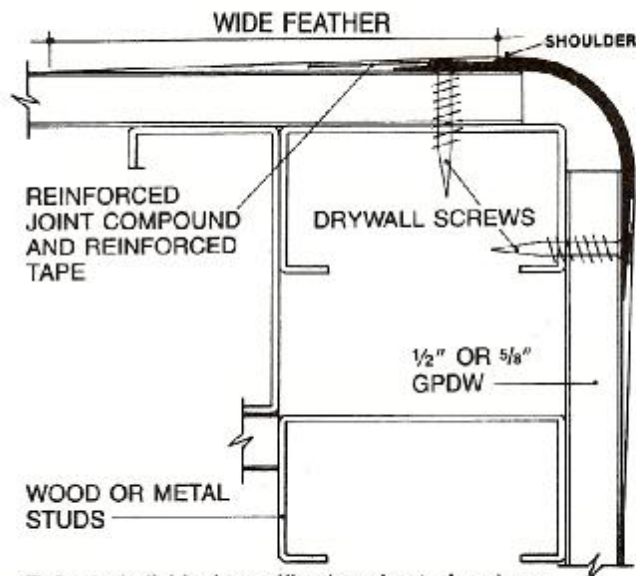

Refer to individual specification sheets for placement of studs.

TROWELS

An 8" wide trowel is the minimum width recommended to properly feather the compound into a smooth, broad joint. A narrow trowel will leave a poor irregular joint.

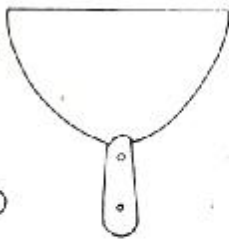
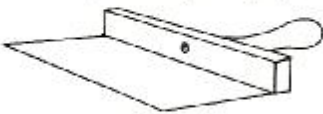

*TAPE & JOINT COMPOUND

Use the best reinforced joint compounds and reinforced tapes. Exterior applications require bond coating and exterior fiberglass joint compounds as an under filler (consult factory). All joint work to be spot sealed or primed to reduce compound porosity.

* Plaster skim coat is not a substitute for tape and joint compound.

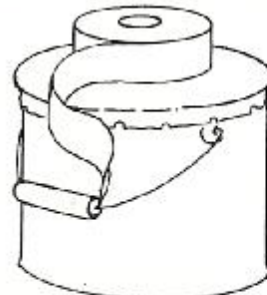

SANDPAPER/ WET SPONGE

Rough sand or wet sponge excess compound. Fine sand with 220 grit to feather out joint.

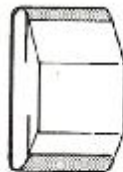
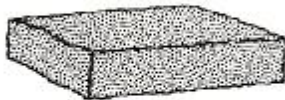

PAINTING

The factory applied SOFTFORMS® primer is compatible with most paints which may be sprayed, brushed or roller coated.

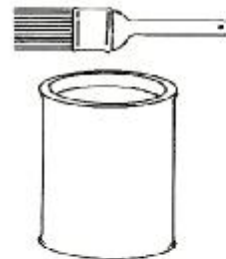
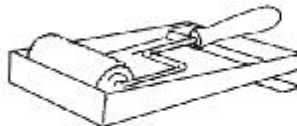

WALL COVERINGS

SOFTFORMS® are perfectly suited to all wall coverings and adhesives. Apply according to manufacturer's recommendations. Inserts which conceal fabric tucked into the SOFTFORMS® reveals must be sized according to fabric thickness.

